



Smart & Simpool

LIFEBUOY

Make Your Pool Safer

BCONE

Installation & Operation Guide

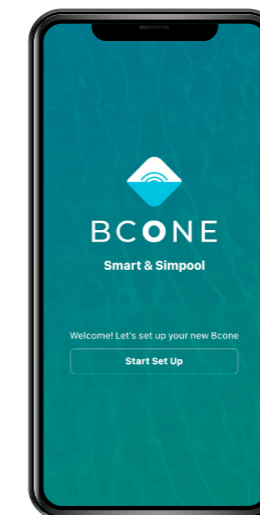

85dB Alarm at 10 Feet



HOME

– **SAFETY**

- General Safety Instructions
- Lithium-ION Batteries Safety Guidelines
- Alkaline Batteries Safety Guidelines

– **INTRODUCTION**

- Overview
- Pool Unit
- Home Unit

– **GETTING STARTED**

- Opening the Box
- Recommendations for Pool Unit Installation
- Recommendations for Home Unit Installation
- Setting Up the Pool Unit
- Starting BCone

– **OPERATION**

- Operation Modes
- On Mode
- Swim Mode
- Off Mode
- Adjusting Sensitivity
- Turning Alarm Off

– **SERVICE**

- Troubleshooting
- Replacing Pool Unit Batteries
- Shut Down and Storage
- Technical Specifications
- Contact Information

– **MULTI BCONE**

- Multi BCone Installation Recommendations
- Adding a Pool Unit
- Multi BCone Operation

SAFETY

GENERAL SAFETY INSTRUCTIONS

- Read this guide fully prior to use.
- BCone is exclusively a safety device and is not a lifesaving product.
- **Under no circumstances should you relate to this product as a substitute for other means of safety, such as a lifeguard, parental supervision, fences, gates and so on.**
- This device may contain small parts that may be a choking hazard to children under 3 years. Keep small parts away from children.
- This device is not a toy, do not allow children to operate or play with it because children could hurt themselves or others or damage the device.
- Without detracting from the aforementioned, your attention is drawn to the fact that the product may not sound a warning in cases of gradual entry into the pool.
- Ensure that the system covers the entire area of the pool and if necessary, adjust the sensitivity of the system.
- Do not leave objects in the pool when the system is activated.
- Opening the home and Pool Unit for service or maintenance must be done by qualified service personnel only, with the exception of opening the Pool Unit battery compartment to replace the batteries ([see Replacing Pool Unit Batteries on page 24](#)).
- Used electrical and electronic products should not be mixed with general household waste.

LITHIUM-ION BATTERIES SAFETY GUIDELINES

The Home Unit contains one rechargeable Lithium-Ion battery. The following list describes the safety guidelines for maintaining and disposing of the battery:

- **Do not try to replace the Home Unit battery** – the battery provided by Lifebuoy is not user replacable.
- Keep the Home Unit at room temperature.
- Store the Home Unit away from anything that might catch fire.

- Stop using the Home Unit if you notice one of the following: odor, excessive heat, change in shape, leakage, odd noises.
- **Battery Disposal** – do not throw the Home Unit or its battery in the trash. Batteries should be disposed of in accordance with local regulations.
- **Battery Charging** – charger requirements for charging the Home Unit is standard DC 5V USB-A charger, with minimum 800ma current.

ALKALINE BATTERIES SAFETY GUIDELINES

The Pool Unit contains two Alkaline batteries. The following list describes the safety guidelines for maintaining and disposing of the batteries:

- Mind the polarity of the batteries when placing them in the battery compartment.
- Do not charge batteries. Charging may result in electrolyte leakage and/or damage.
- When replacing batteries, replace all of them at the same time with new batteries of the same type.
- Exhausted batteries should be immediately removed from the equipment and disposed of.
- Do not heat batteries.
- Do not dispose of batteries in fire.
- Keep batteries out of the reach of children. Do not allow children to replace batteries without adult supervision.
- **Battery Disposal** – do not throw batteries in the trash. Discard batteries at an appropriate recycling location. Batteries shall be disposed of in accordance with local regulations.

COMPLIANCE INFORMATION

European Community

This equipment complies with:

- IP68 Waterproof
- Low Voltage Directive (LVD) 2014/35/EU
- Electromagnetic Compatibility (EMC) Directive, 2014/30/EU
- Radio Equipment Directive (RED), 2014/53/EU
- WEEE Directive 2002/96/EC
- Restriction of Hazardous Substances Directive (RoHS) 2011/65/EU
- Lead-Free Compliance

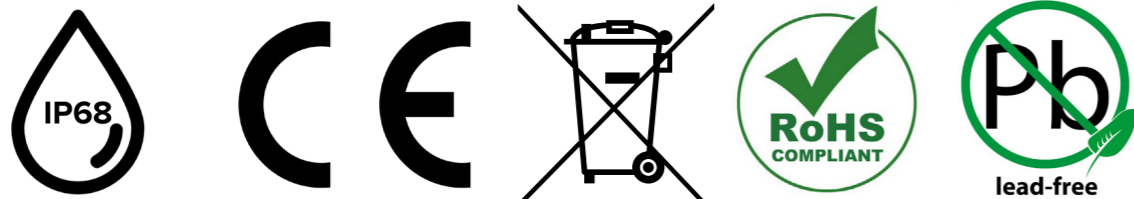

ASTM



MODEL **LBPABCHU01/ LBPABCPU01** Meets requirements of ASTM Safety Specification F2208.

Alarm level is 85dB at 10 Feet.

Important: This device is not intended to replace any other safety consideration; that is, adult supervision, lifeguards, fences, gates, pool covers, locks, and so forth, and some devices may not detect gradual entry.

FCC (Federal Communications Commission) - The United States of America

BCone Home Unit model: **LBPABCHU01**

BCone Pool Unit Model: **LBPABCPU01**

BCone Home Unit FCCID: **2AOXNBCHU1**

BCone Pool Unit FCCID: **2AOXNBCPU1**

Contains FCC ID: **QOQWFM200**

This device complies with part 15 of the FCC Rules. Operation is subject to the following two conditions:

- (1) This device may not cause harmful interference, and
- (2) This device must accept any interference received, including interference that may cause undesired operation.

Note: This equipment has been tested and found to comply with the limits for a Class B digital device, pursuant to Part 15 of the FCC Rules. These limits are designed to provide reasonable protection against harmful interference in a residential installation. This equipment generates, uses and can radiate radio frequency energy and, if not installed and used in accordance with the instructions, may cause harmful interference to radio communications. However, there is no guarantee that interference will not occur in a particular installation. If this equipment does cause harmful interference to radio or television reception, which can be determined by turning the equipment off and on, the user is encouraged to try to correct the interference by one or more of the following measures:

- Reorient or relocate the receiving antenna.
- Increase the separation between the equipment and receiver.
- Connect the equipment into an outlet on a circuit different from that to which the receiver is connected.
- Consult the dealer or an experienced radio/TV technician for help.

Important: Changes or modifications to this equipment not expressly approved by the party responsible for compliance (Lifebuoy Ltd.) could void the user's authority to operate the equipment.

Warning: To comply with FCC RF Exposure compliance requirements, the device (**Home Unit**) should be located at a distance of at least 20 cm from all persons during normal operation, and the device (**Pool Unit**) should be located at a distance of at least 5 cm from all persons during normal operation. These specifications are due to the typical device usage and the internal construction of the antenna with plastic enclosure providing these distances. The antennas used for this product must not be co-located or operated in conjunction with any other antenna or transmitter.

IC Canada ID:

BCone Home Unit IC: **27681-BCHU1**

BCone Home Unit Contains IC: **5123A-WFM200**

BCone Pool Unit IC: **27681-BCPU1**

This Class B digital apparatus complies with Canadian ICES-003.

Cet appareil numérique de la classe B est conforme à la norme NMB-003 du Canada.

IC Statements

This device contains licence-exempt transmitter(s)/receiver(s) that comply with Innovation, Science and Economic Development Canada's licence-exempt RSS(s). Operation is subject to the following two conditions:

- (1) This device may not cause interference.
- (2) This device must accept any interference, including interference that may cause undesired operation of the device.

L'émetteur/récepteur exempt de licence contenu dans le présent appareil est conforme aux CNR d'Innovation, Sciences et Développement économique Canada applicables aux appareils radio exempts de licence. L'exploitation est autorisée aux deux conditions suivantes :

- 1) L'appareil ne doit pas produire de brouillage;
- 2) L'appareil doit accepter tout brouillage radioélectrique subi, même si le brouillage est susceptible d'en compromettre le fonctionnement.



NOTE: To view the Regulatory ID for this device, on the BCone app, go to the About section, or visit www.lifebuoyalarm.com

INTRODUCTION

This chapter introduces the BCone system and includes:

- **Overview**
- **Pool Unit**
- **Home Unit**

OVERVIEW

BCone system includes the following components:

Pool Unit – attached to the side of the pool and floats on the water.
The Pool Unit sounds an alarm and transmits alerts to the Home Unit.

Home Unit – located in the house, connected to the home Wi-Fi, communicates with the Pool Unit and sounds an alarm when needed.
Enables controlling and monitoring up to four Pool Units.

Mobile Application – BCone mobile application, communicates with the Home Unit and sends notifications when needed.
Provides access to the system settings and allows for remote monitoring.



POOL UNIT

The Pool Unit includes the following components:

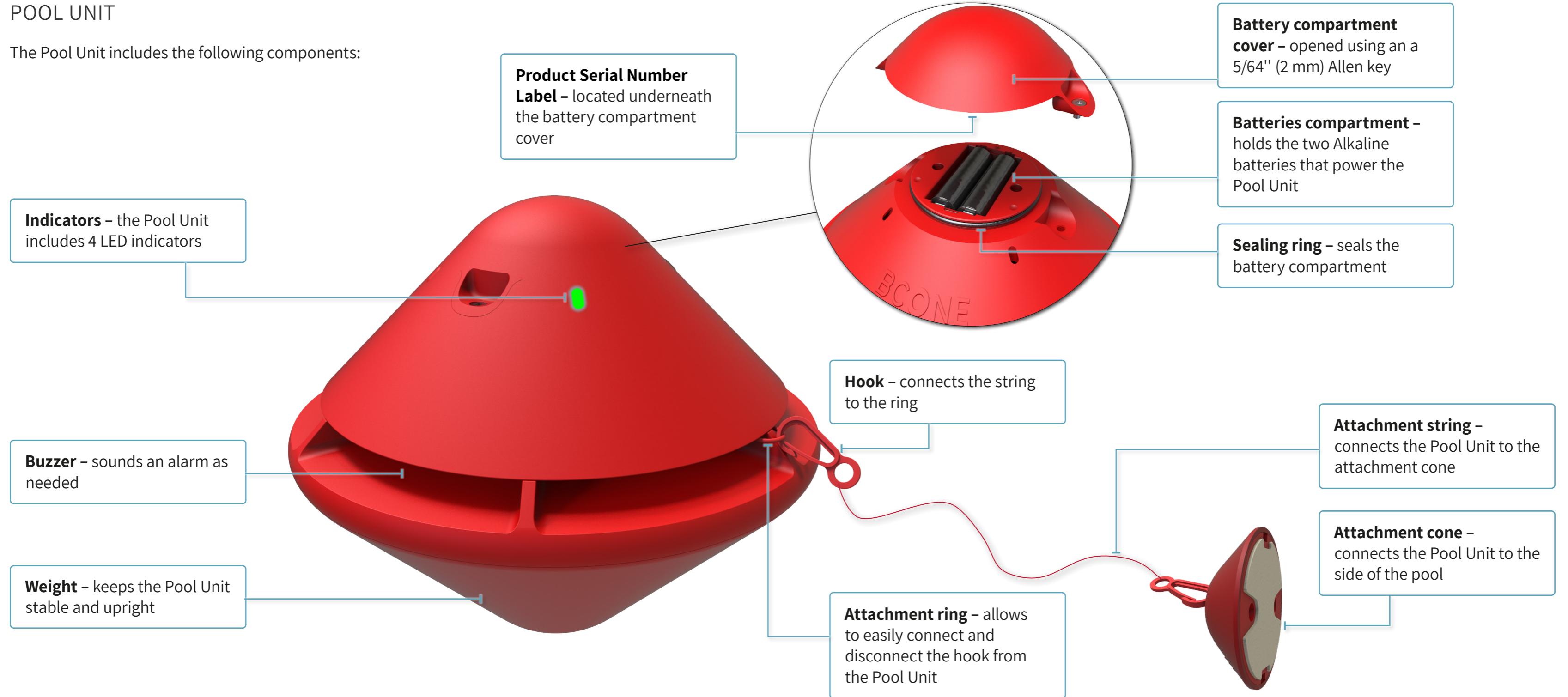

HOME UNIT

The Home Unit includes the following components:

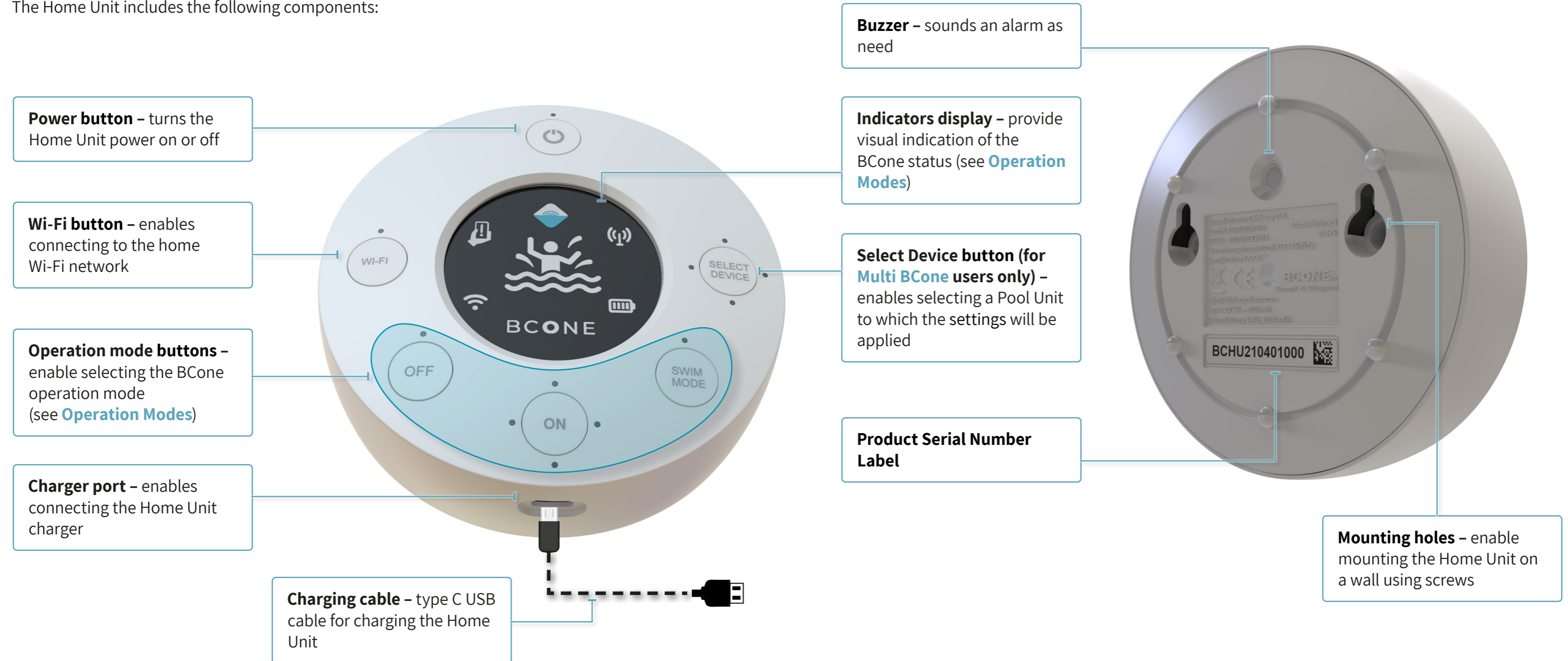





GETTING STARTED

This chapter reviews the BCone first time use and includes:

- **Opening the Box**
- **Recommendations for Pool Unit Installation**
- **Setting Up the Pool Unit**
- **Starting BCone**

OPENING THE BOX

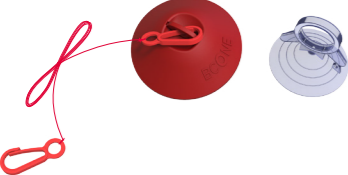
The BCone Pool Alarm System package contains the following:

	ITEM	QTY	COMMENTS
	Pool Unit	1	Includes 2 AA batteries.
	Home Unit	1	Includes a rechargeable lithium battery.
	Attachment Kit	1	The attachment kit includes: 1 attachment cone 1 suction cup 1 attachment string 2 hooks
	Type C USB Cable	1	For charging the Home Unit. (Power adapter not included)
	Quick Start Guide	1	



NOTE: The box is made from durable cardboard and has been specially designed to protect the contents. If the box arrived open or damaged or if a part is missing, please contact our customer service 1-800-720-7160 / info@lifebuoyalarm.com



RECOMMENDATIONS FOR POOL UNIT INSTALLATION

Consider the following guidelines before installing the Pool Unit:

- A single Pool Unit can cover pool area of 20' x 40'.
- Place the Pool Unit away from any obstruction in the pool, such as a pool drain or any other pool element.
- Use the provided attachment kit to anchor the Pool Unit.
- Place the Pool Unit so that it is in line of sight with the wall on which the Home Unit is installed.
- Depending on the pool shape, place the Pool Unit according to the drawing.

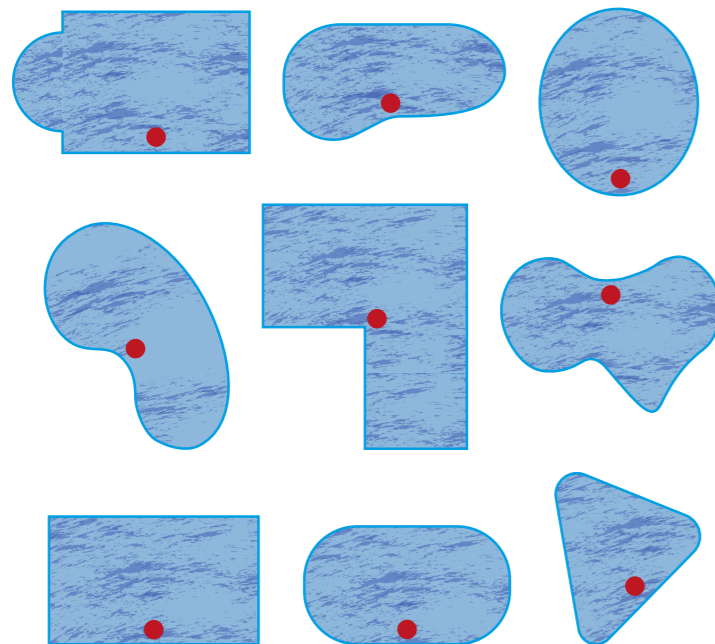

NOTE: For Multi BCone installation, see [Multi BCone Installation Recommendations](#).

RECOMMENDATIONS FOR HOME UNIT INSTALLATION

Consider the following guidelines before installing the Home Unit:

- The Home Unit should be installed inside the house, on the wall closest to the Pool Unit.
- It is recommended to mount the Home Unit on the wall using two screws (not provided)
- The Home Unit should be installed close to an electrical outlet to allow charging.
- The Home Unit should be installed within Wi-Fi range to allow proper connection to the Internet.

SETTING UP THE POOL UNIT

Perform the following steps to set up the Pool Unit:

NOTE: Choose the Pool Unit location based on the [Recommendations for Pool Unit Installation](#).

NOTE: The Pool Unit is delivered operational and already paired with the Home Unit. There is no need to turn on the Pool Unit power.

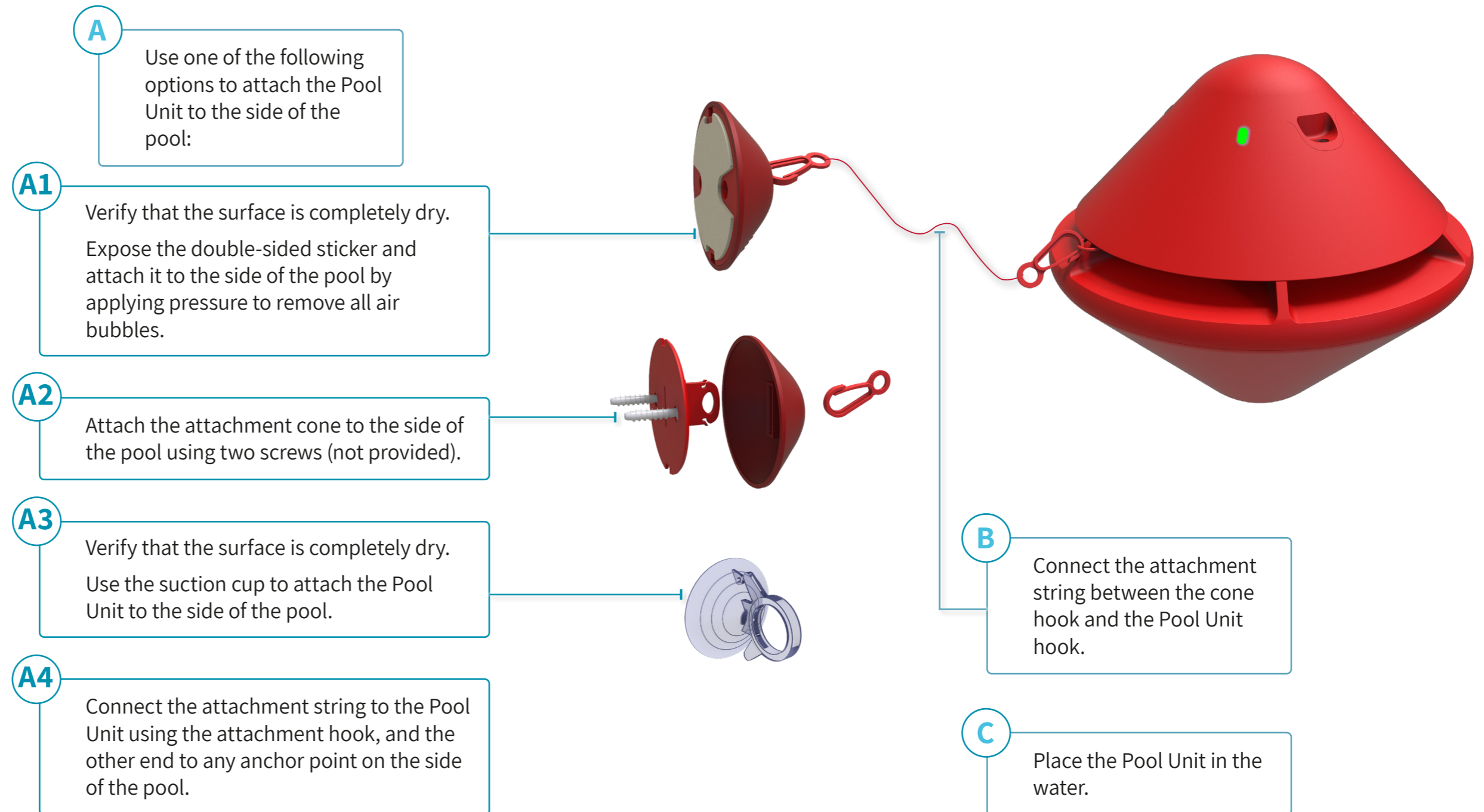

STARTING BCONE

STARTING USING THE APP

Once the Home Unit and Pool Unit are set up, perform the following steps to set up BCone using the mobile app:

A Download the BCone mobile application from Apple App Store



or Google Play Store



TIP: Scanning the QR code using a mobile device links directly to BCone application download page.



TIP: BCone mobile application works with both Amazon Alexa and Google Assistant.

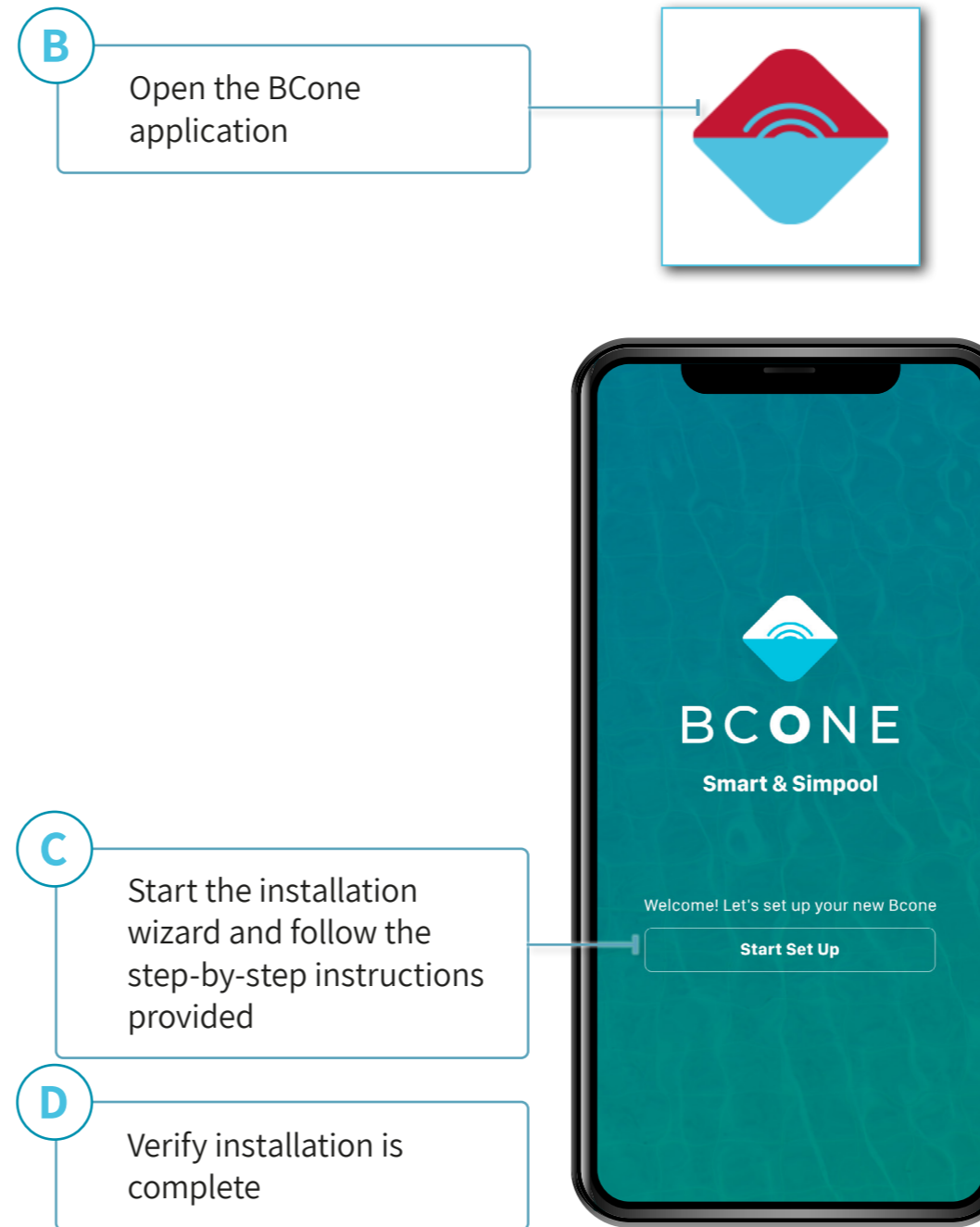

NOTE: When using BCone without the mobile application, BCone is ready once the Home Unit and the Pool Unit are set up.

OPERATION

This chapter reviews the BCone routine operation and includes:

- **Operation Modes**
- **On Mode**
- **Swim Mode**
- **Adjusting Sensitivity**
- **Turning Alarm Off**

OPERATION MODES

Select one of the following operation modes according to the current use of the pool:



ON MODE

On mode is used when the pool is not being used and there is a need to detect entrance to the pool.

Perform the following steps to switch to On mode:

Via the Home Unit

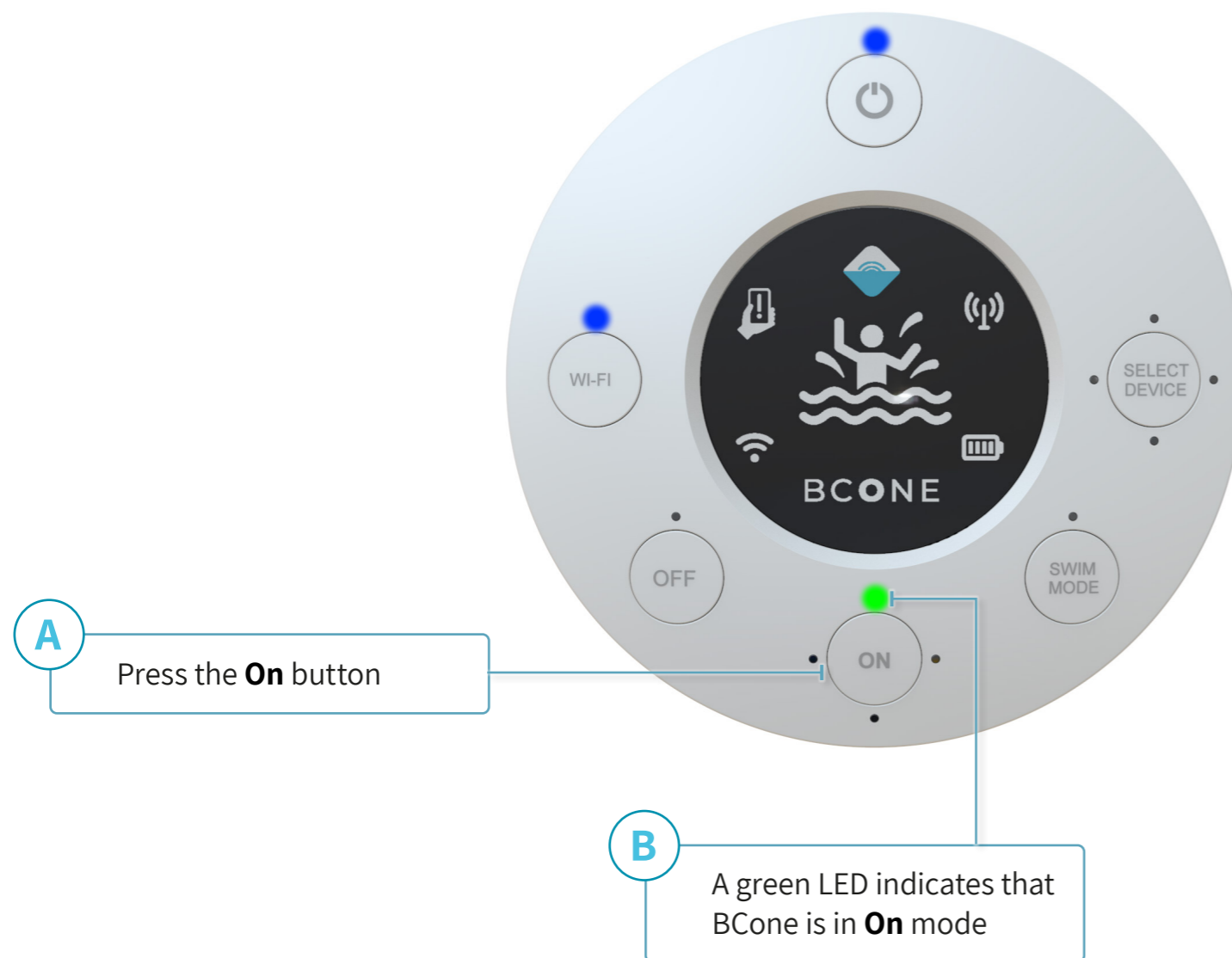

Via the Mobile Application

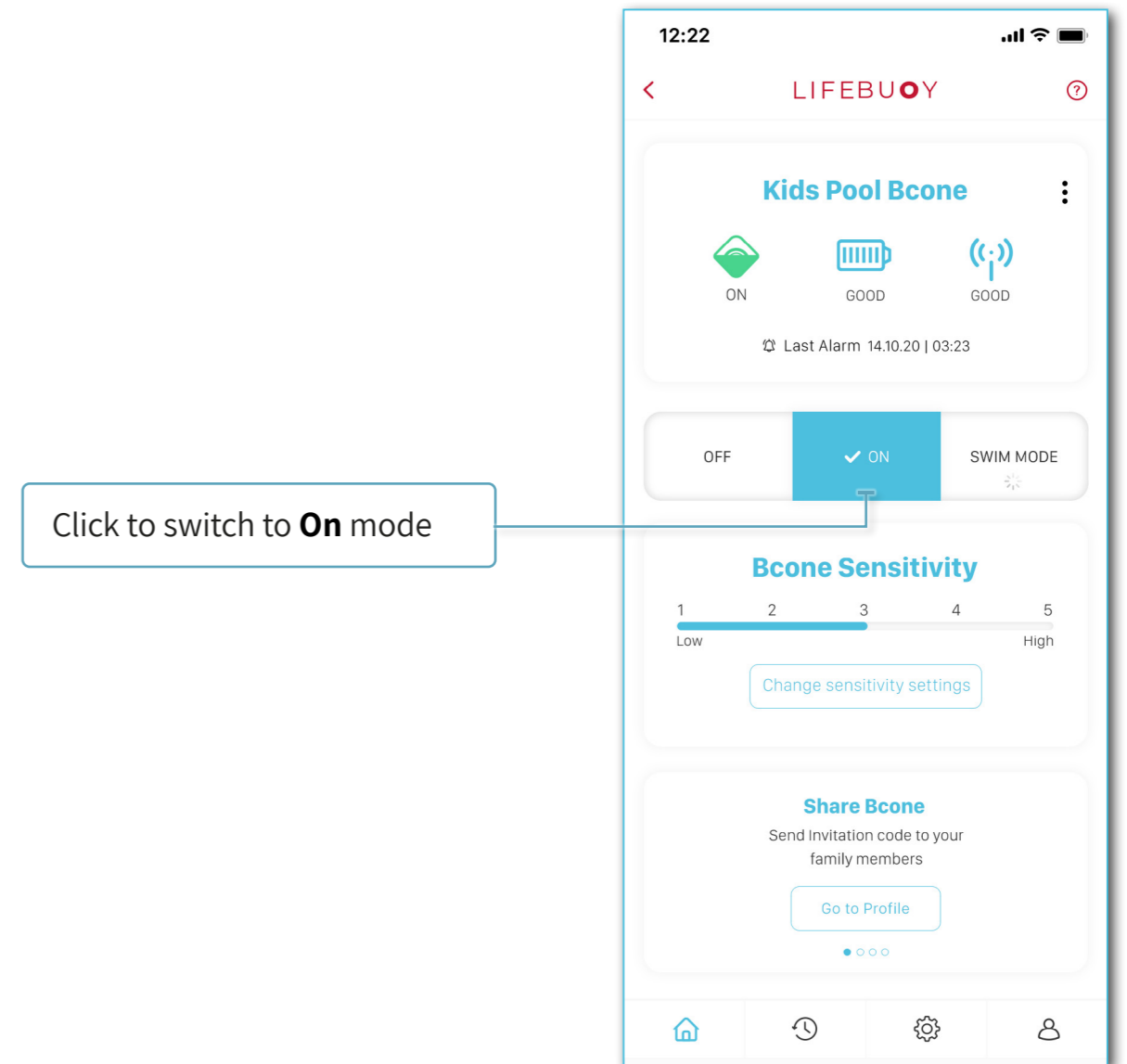

SWIM MODE

Swim Mode is used when the pool is in use. When BCone senses several minutes without activity, it goes back to On mode automatically.

Perform the following steps to switch to Swim mode:

Via the Home Unit

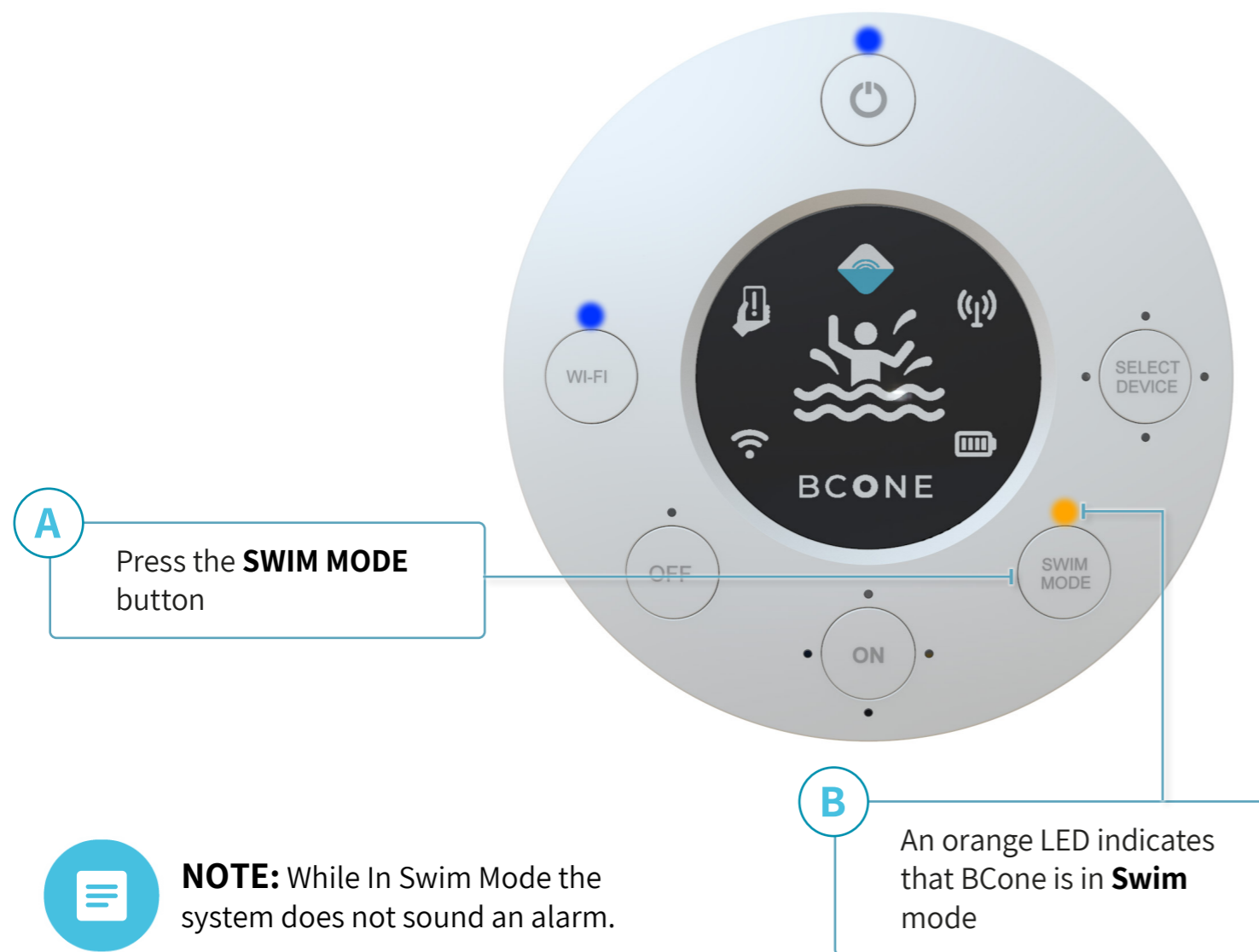

Via the Mobile Application

Click to switch to **Swim** mode

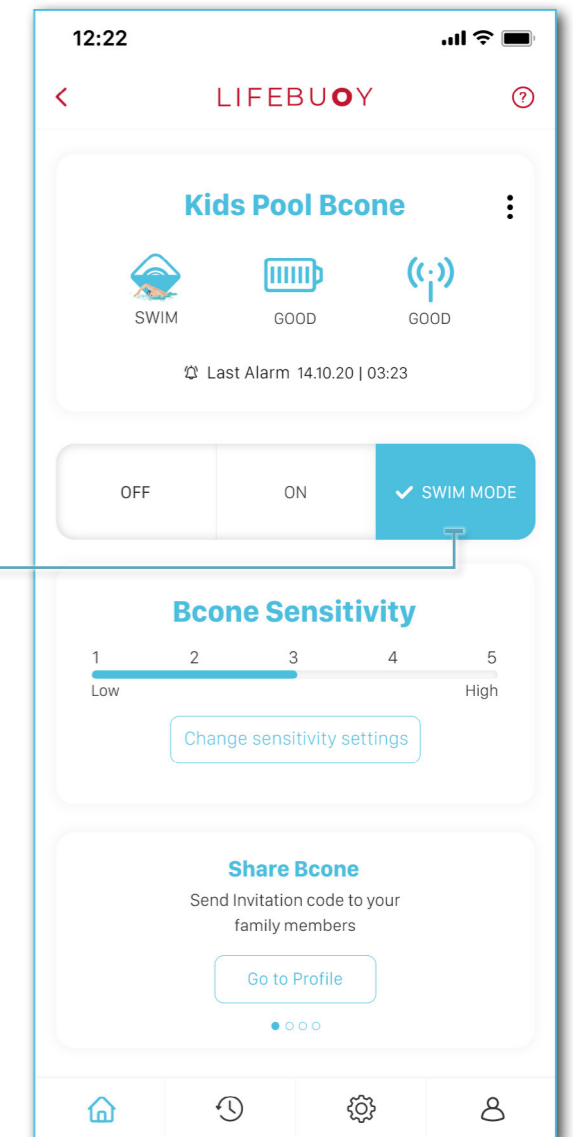

TIP: Switching to Swim mode is also possible by taking the Pool Unit out of the water and holding it vertically for a few seconds. The Pool Unit beeps twice to indicate it is in Swim mode.



OFF MODE

Off mode is used to turn off the Pool Unit. In Off mode, the system does not sound an alarm when an entrance to the pool is detected.

Perform the following steps to switch to Off mode:

Via the Home Unit

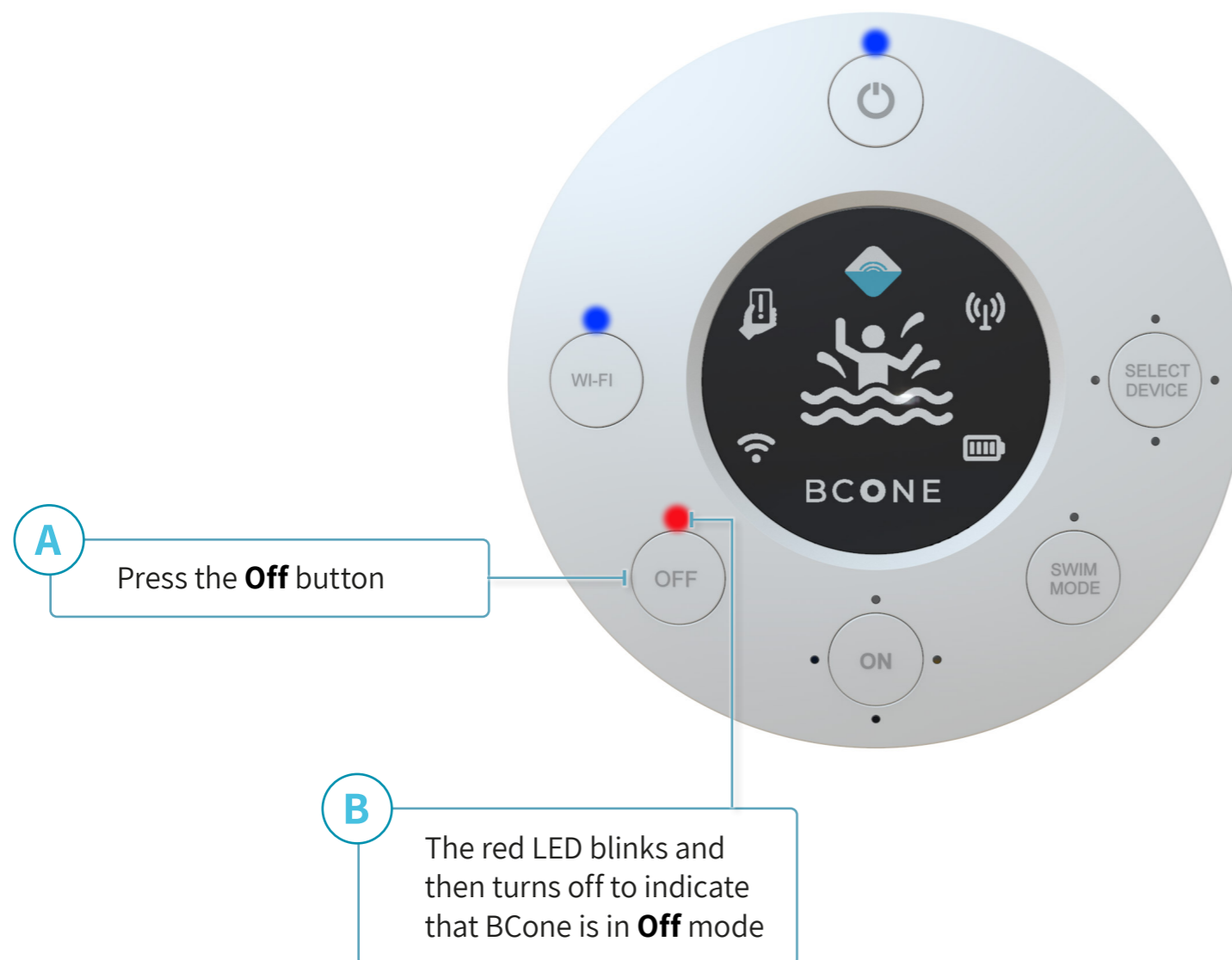

Via the Mobile Application

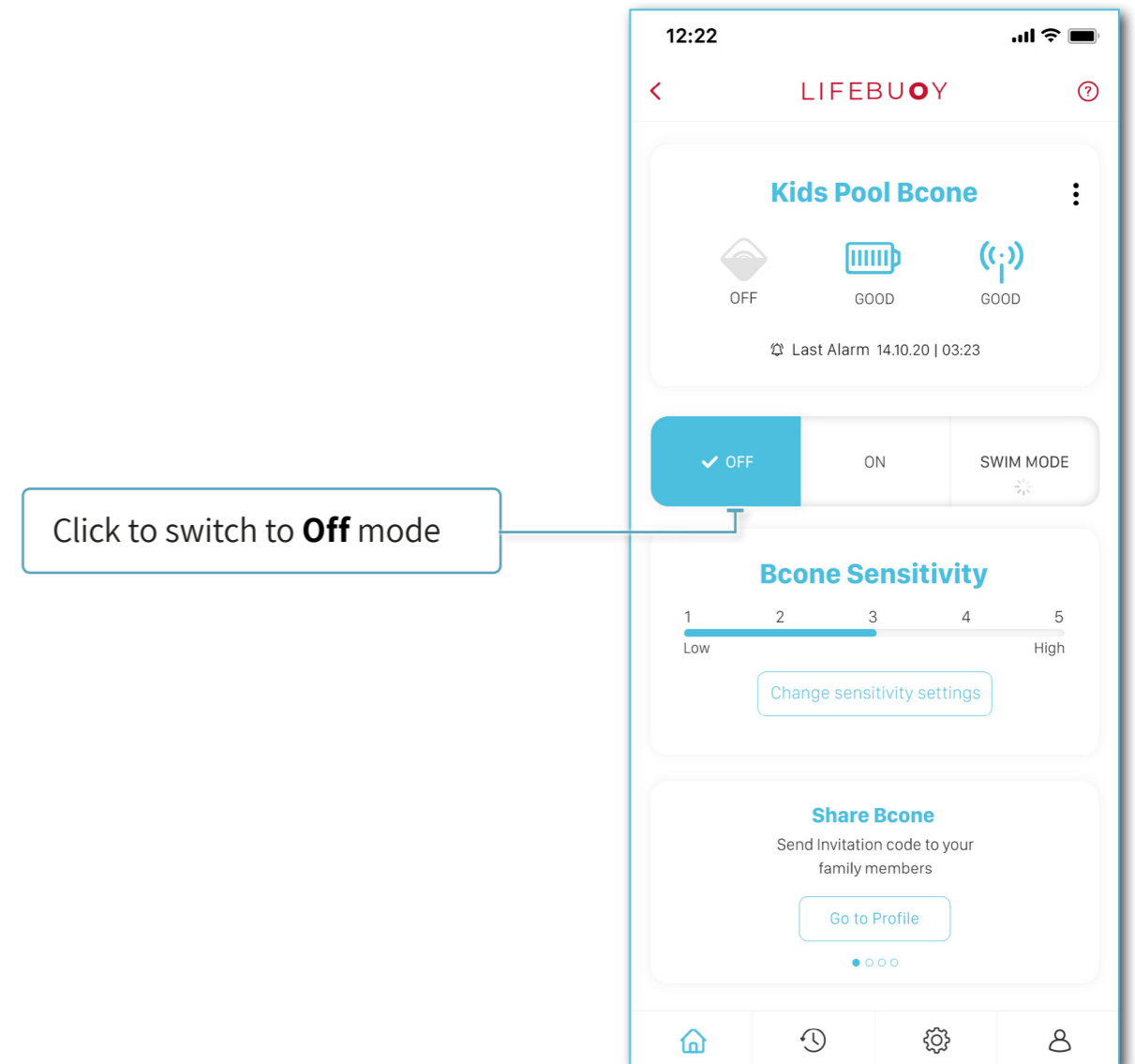

ADJUSTING SENSITIVITY

BCone sensitivity levels determine the reaction of the Pool Unit to water movement.

The lowest sensitivity level means the Pool Unit sensor is triggered only by sizable waves. The highest sensitivity level means the Pool Unit sensor is triggered by smaller ripples or waves.

The default sensitivity level is 3. Perform the following steps to set the sensitivity level:

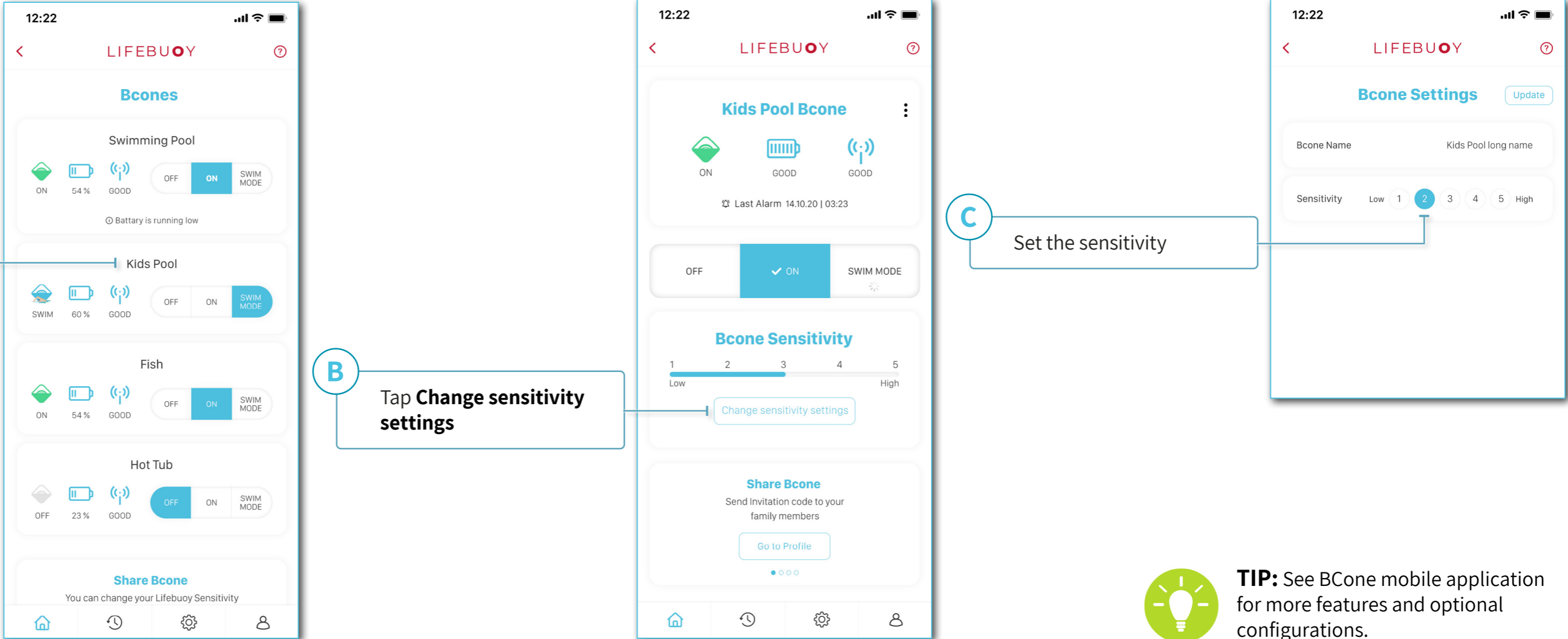

A Select the relevant Bcone

B Tap **Change sensitivity settings**

C Set the sensitivity

TIP: See BCone mobile application for more features and optional configurations.

TURNING ALARM OFF

When BCone is triggered, the following indicators occur:

The **Home Unit** and **Pool Unit** sound an alarm, and the **mobile application** displays a notification.



The **Pool Unit** LEDs blink red.

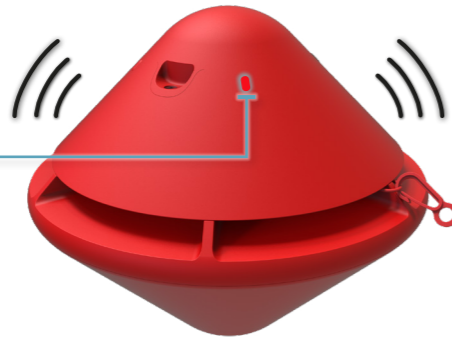

The **Home Unit** Alarm LED display blinks red.

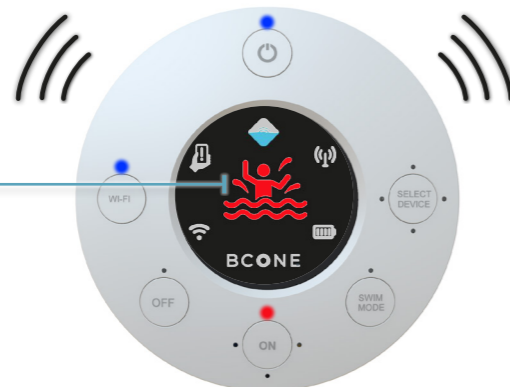

After checking the pool and verifying that no one is in danger of drowning, perform one of the following options to silence the alarm:

Swipe the screen on the **mobile application**.

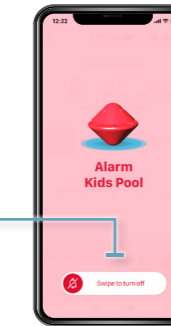

Take the **Pool Unit** out of the water and hold it vertically for a few seconds. The Pool Unit will beep twice to indicate it is in Swim mode.

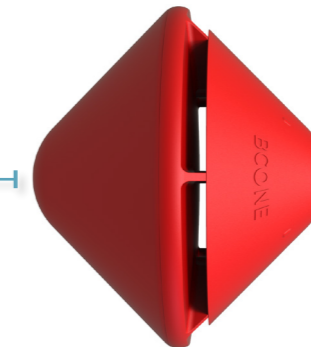

Press any button on the **Home Unit**.

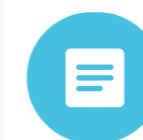
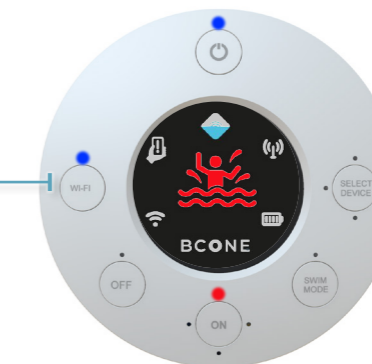

NOTE: Once the alarm is silenced, BCone switches to **Swim Mode** and automatically turns back on once the pool is calm for several minutes.

SERVICE

This chapter reviews the BCone service and includes:

- [Troubleshooting](#)
- [Replacing Pool Unit Batteries](#)
- [Shut Down and Storage](#)
- [Technical Specifications](#)



NOTE: Should any issues arise with the home or Pool Unit, contact technical support:

www.lifebuoyalarm.com / info@lifebuoyalarm.com

Toll free US & Canada only: 1800-720-7160



CAUTION: Opening the home and Pool Unit for service or maintenance must be done by qualified service personnel only, with the exception of opening the Pool Unit battery compartment to replace the batteries ([see Replacing Pool Unit Batteries on page 24](#)).

TROUBLESHOOTING



Mobile Alert – Indicates an issue that cannot be displayed on the Home Unit.
Resolution – Check the mobile application.



Connectivity Issue – Indicates a problem with the connection between the Pool Unit and the Home Unit.
Resolution –

1. Make sure that Pool Unit is floating vertically in the pool (it will not communicate otherwise)
2. Place the Home Unit closer to the Pool Unit.
3. Verify that the Pool Unit batteries are not drained.



Wi-Fi Connection Issue – Indicates a Wi-Fi connection issue.
Resolution –

1. Check that the home Wi-Fi router is working properly.
2. Place the Home Unit closer to the Wi-Fi router.



Low Battery Alert – A blinking battery icon indicates low Home Unit battery.
Resolution – Charge the Home Unit using the supplied charging cable. When the Home Unit is charging, the battery icon is on. When the battery icon turns off, it indicates full battery.



Low Pool Unit Battery Alert – Both mobile device icon and battery icon are simultaneously on it indicates low Pool Unit battery.
Resolution – See section [Replacing Pool Unit Batteries](#).



CAUTION: The Home Unit battery is not replaceable.



NOTE: When BCone is in On mode, issues related to the Pool Unit are also indicated by the On button LED blinking red.



REPLACING POOL UNIT BATTERIES

The Pool Unit is delivered with two Alkaline batteries already installed. When the Home Unit icons indicate low Pool Unit battery (both mobile device icon and battery icon are lit simultaneously), it is advisable to change the batteries as soon as possible.

Perform the following steps to change the Pool Unit batteries:



TIP: For best performance use the Alkaline batteries provided by Lifebuoy, available on the company website.

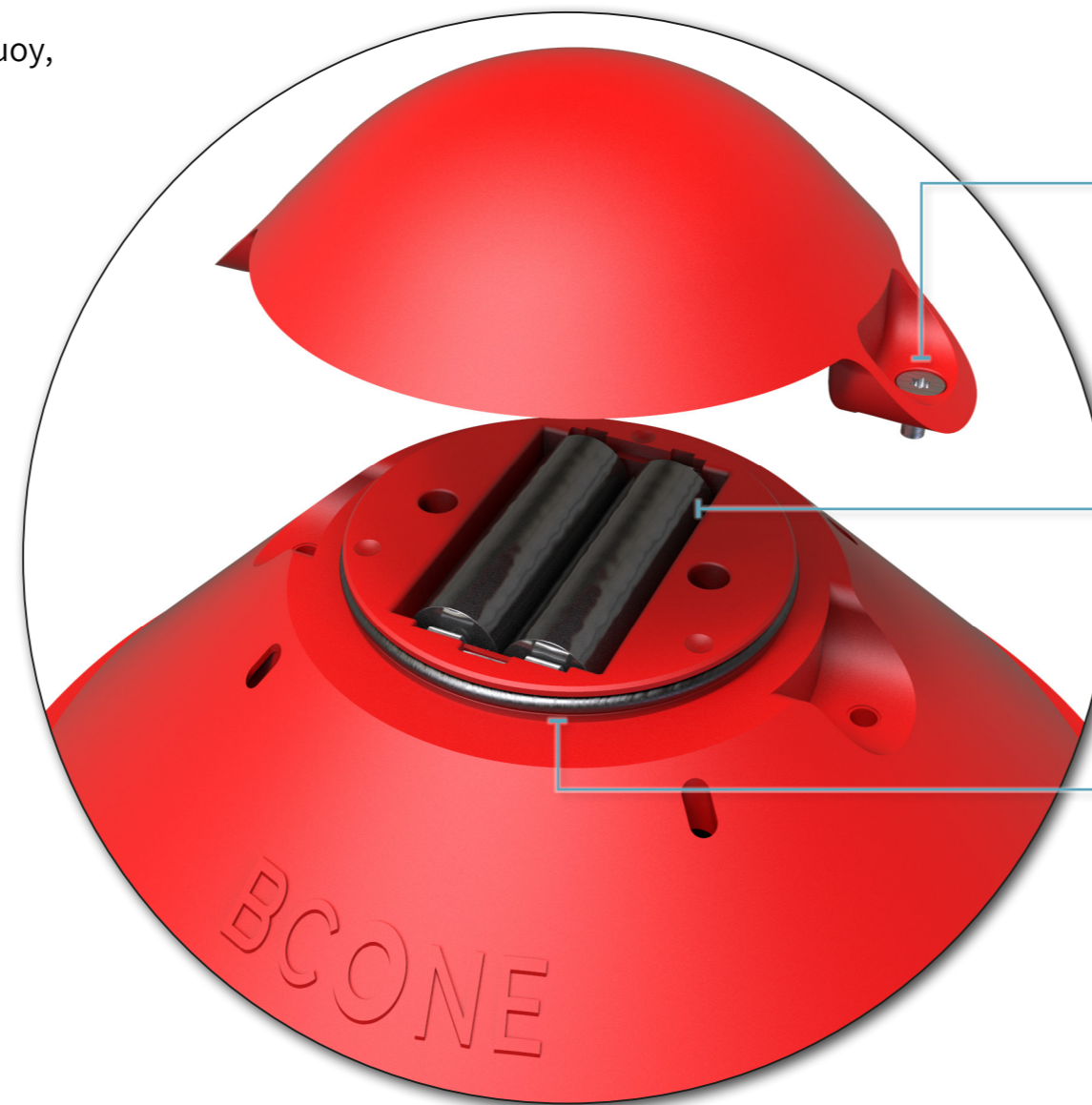

A Using a 5/64" (2 mm) Allen key, unscrew the two screws and remove the top cover.

B Remove the old batteries and place new AA batteries. Mind the polarity of the batteries.

C Verify that the seal is in place and is clean.

D Reattach the top cover by fastening the two screws.

SHUT DOWN AND STORAGE

During the off season, perform the following steps to shut down and store BCone:

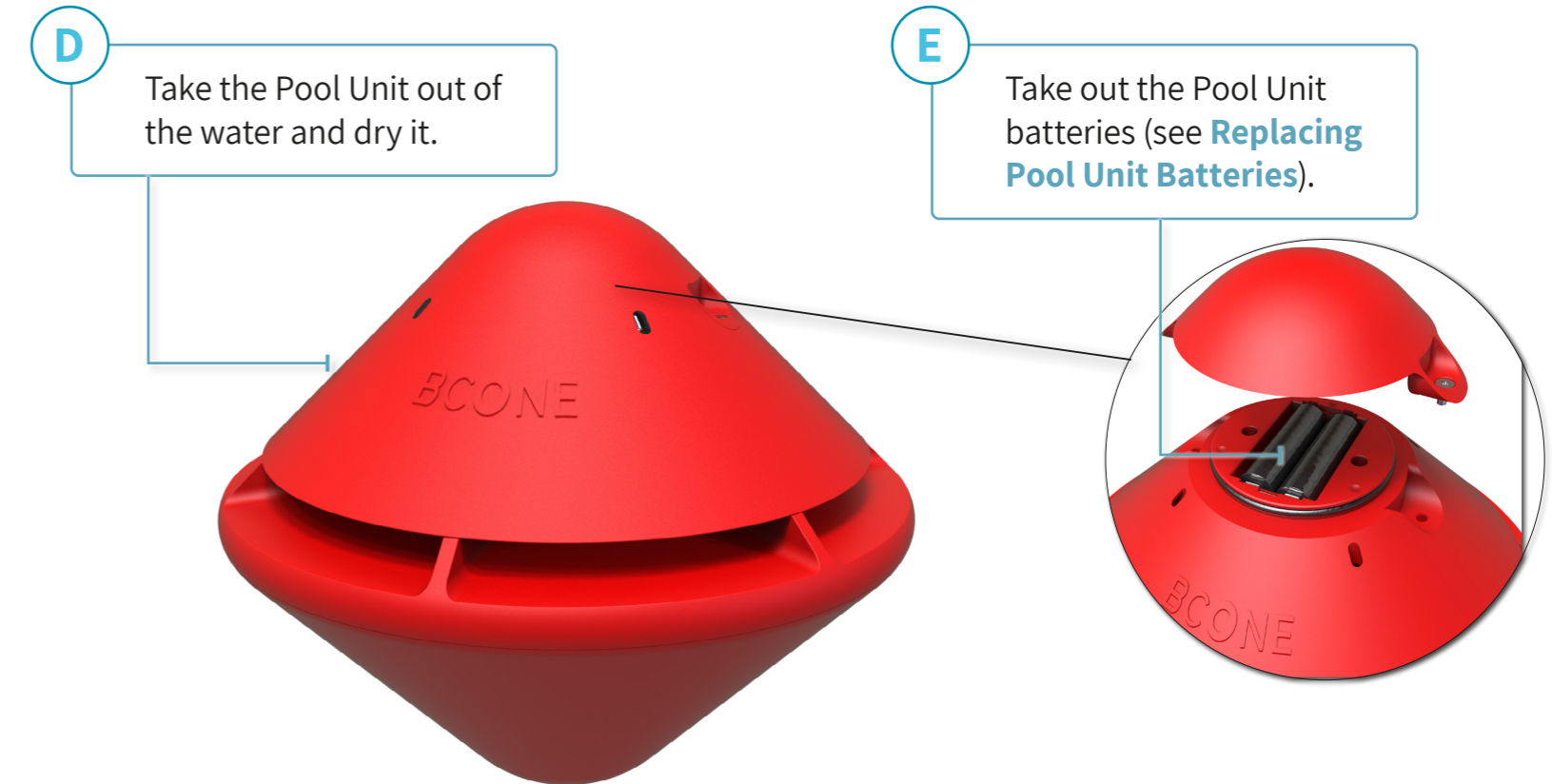
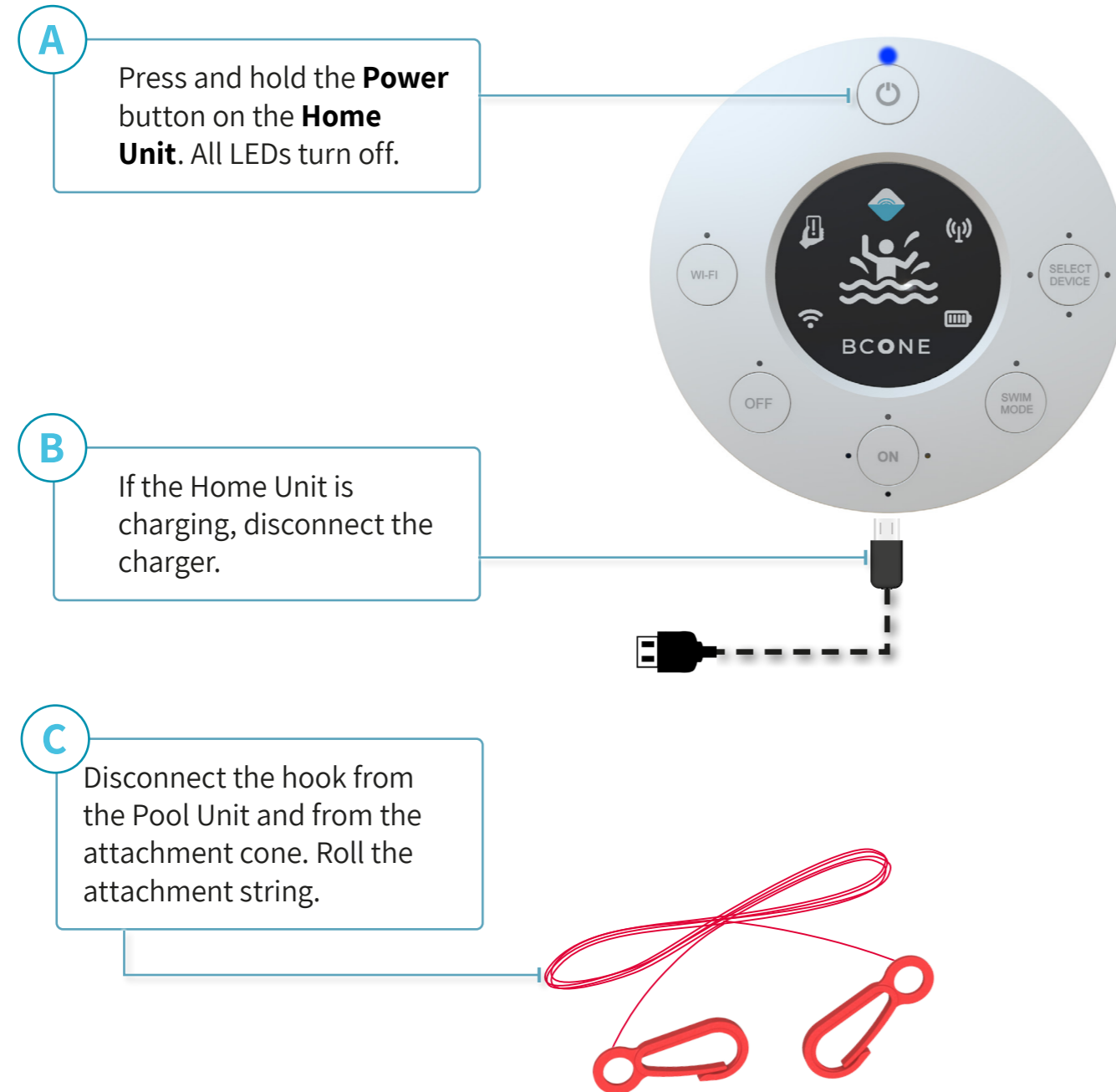

NOTE: If the attachment cone is attached using the double sided tape or anchored using screws, it should remain in place and not be removed.



F Store the Home Unit, Pool Unit, batteries, suction cup, screws and charging cable in a cool and dry place, preferably in the original box.

TECHNICAL SPECIFICATIONS

BCone includes the following specifications:

- **BCone Home Unit model** – LBPABCHU01
- **BCone Pool Unit model**– LBPABCPU01
- **Alarm level of both the home and Pool Unit is 85 dB at 10 feet (complies with ASTM F-2208 standard)**
- **Minimum and maximum ambient temperature** – 32°F-113°F (0°C-45°C)
- **Temperature range for charging battery** – 32°F-113°F (0°C-45°C)
- **Home Unit operating voltage** –
Input: DC5V 800mA
Li-ion Battery 3.7V
- **Pool Unit batteries** – two 1.5 V AA Alkaline batteries
- **Home Unit battery** – 3.7V Li-ion battery



CAUTION: AA Alkaline batteries may explode or leak if recharged, inserted improperly or disposed of in fire. Do not open battery.



CAUTION: Only use and store Li-ion batteries at temperatures of between 32°F and 113°F (0°C-45°C). Keep away from heat and open flames – risk of explosion. Do not immerse in liquids. Do not open battery.

- **QR Code for mobile application download–**



CONTACT INFORMATION

Manufacturer: Lifebuoy Ltd.

Website: www.lifebuoyalarm.com

Email: info@lifebuoyalarm.com

Toll free US & Canada only: 1800-720-7160

Made in Israel

MULTI BCONE

This chapter reviews the the option of using more than one Pool Unit, and includes:

- **Multi BCone Installation Recommendations**
- **Adding a Pool Unit**
- **Multi BCone Operation**

MULTI BCONE INSTALLATION RECOMMENDATIONS

The BCone system allows pairing up to 4 Pool Units with a single Home Unit. Multiple Pool Units can be installed in one pool or in up to 4 pools.

NOTE: Follow the guidelines in [Recommendations for Pool Unit Installation](#).

When placing two Pool Units in one pool, depending on the pool shape, place the Pool Units according to the drawing below.

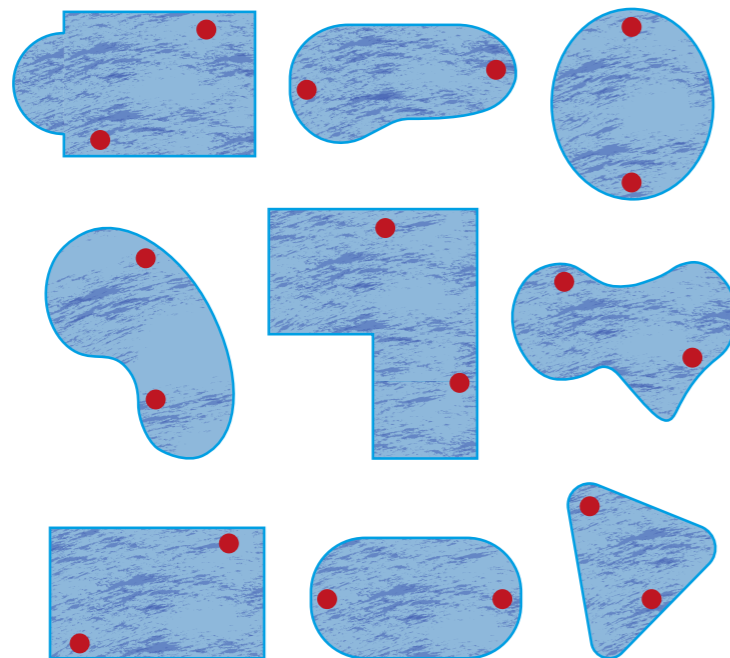

ADDING A POOL UNIT

Perform the following steps to pair an additional Pool Unit with the Home Unit:

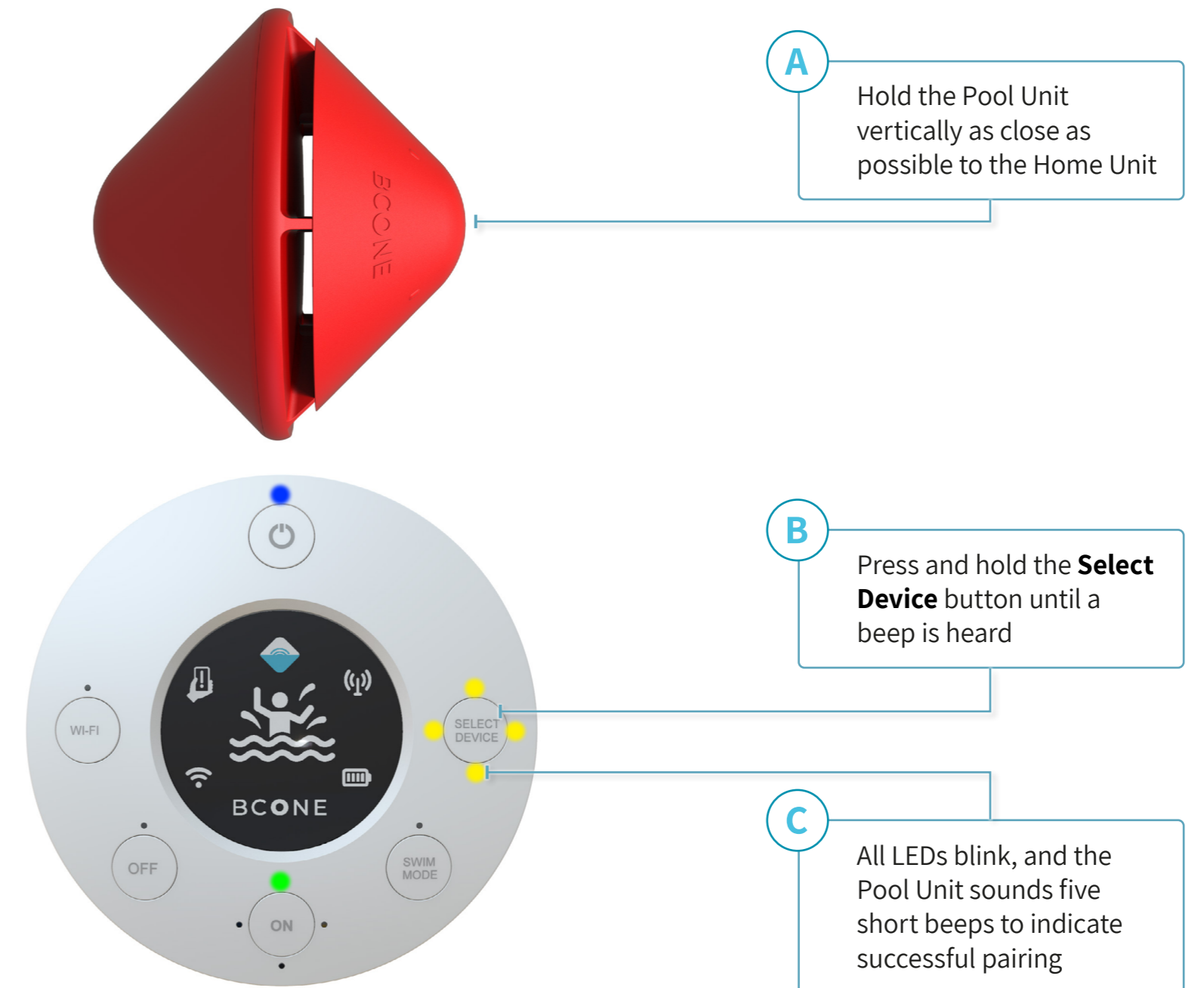

MULTI BCONE OPERATION

When multiple Pool Units are paired with one Home Unit, the Pool Unit must be selected before an operation mode is set. The Select Device button alternates between the multiple Pool Units. The LEDs indicate the Pool Unit that is currently selected.

Press the Select Device button to light the LED of the relevant Pool Unit (i.e. press once to select the first Pool Unit, press twice to select the second Pool Unit, and so on).

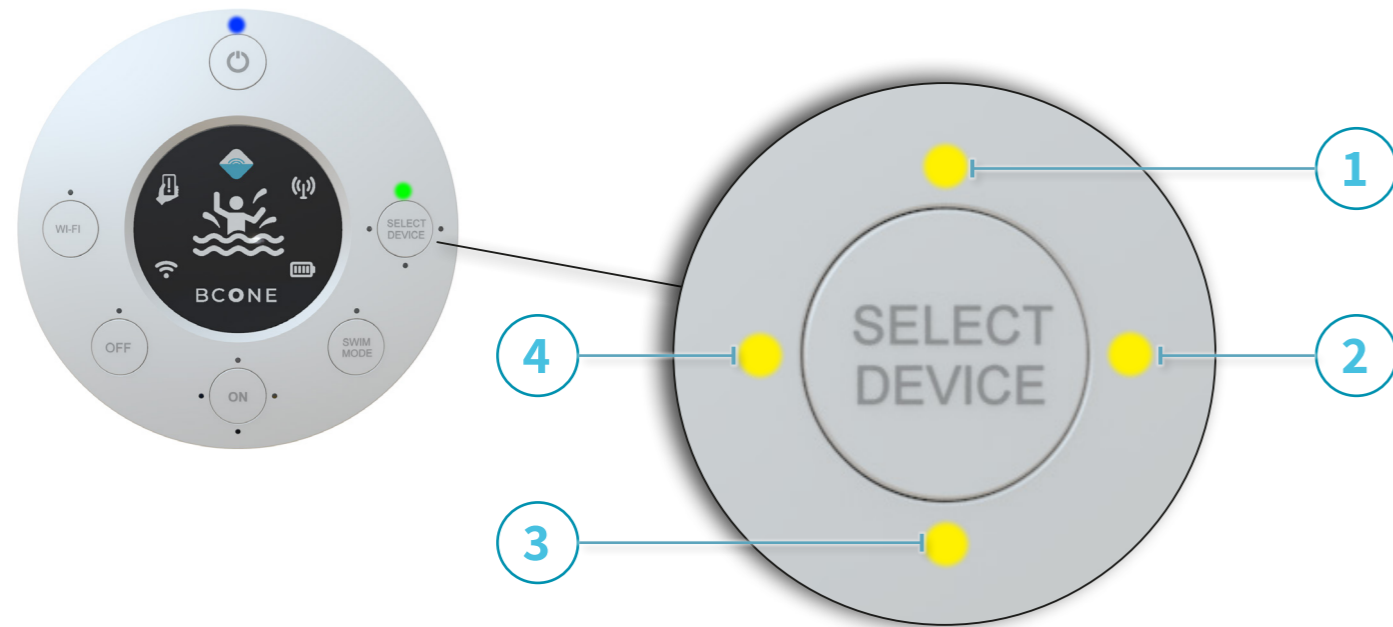

After selecting a Pool Unit, one of the operation mode LEDs lights up for a few seconds to indicate the current operation mode.

To change the Operation Mode for the selected Pool Unit, see [Operation Modes](#).

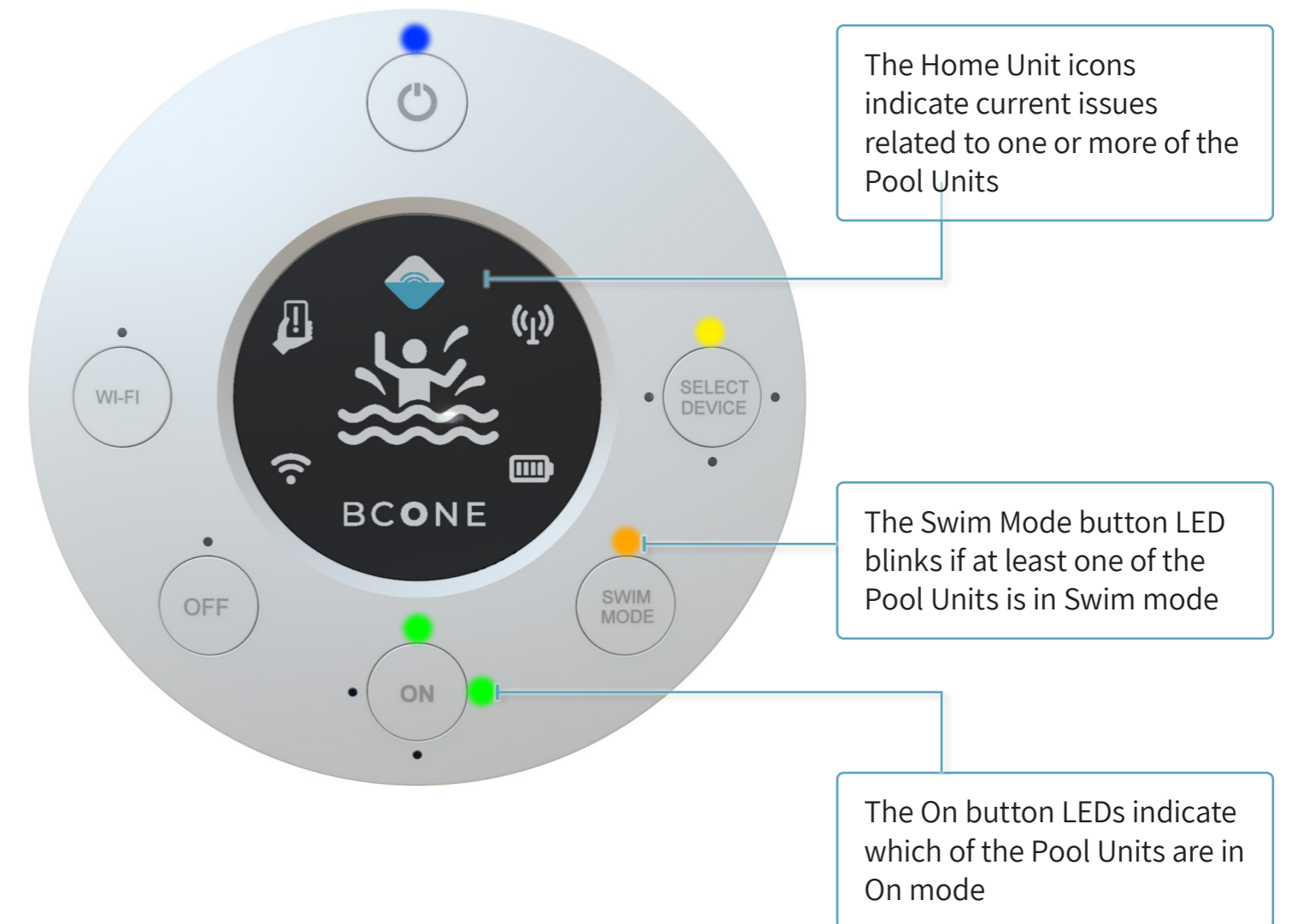

THANK YOU!

LIFEBUOY

Make Your Pool Safer



Yuvalim Business Campus,
Ness Ziona,
Israel



info@lifebuoyalarm.com

Copyright © 2021-2022 Lifebuoy, all rights reserved. No part of this publication may be reproduced, transmitted, transcribed, stored in a retrieval system, or translated into any language or computer language, in any form or by any means, electronic, mechanical or otherwise without prior written permission of Lifebuoy.

Rev B | Doc P/N: BC-00-70-002